

H. O. CO. ACREAGE 177 SUB NO. John Huffman SURVEY Hardin COUNTY, ABSTRACT NO. 261

Acres found 177 Patentee..... Estimated by Lynes, Gleason & Magee Date November 21, 1910  
 Timber Rights Expire..... Mineral Rights Expire..... H. O. Co. Represented by.....  
 Encroachments, Conflict, Trespass, Houses, Fences, Fields None  
 Has Land Been Cut Over? No When..... By..... Class of Timber Cut.....  
 Topography Flat Soil Sandy  
 Adaptable for Grazing and Agriculture Indications of.....

PINE REPRODUCTION			
Area No.	A	B	
Acres	100	57	
L. L. Seedlings			
S. L. Seedlings			
L. L. 7"	11M		
L. L. 8" to 11"	47M		
S. L. 7"		4M	
S. L. 8" to 11"		17M	
Total Feet	58M	21M	

MERCHANTABLE PINE (M. FEET) HERRING LOG SCALE—OUTSIDE BARK MEASUREMENT								
AREA NO.	ACRES	LONG LEAF		SHORT LEAF		LOGS TO TREE	LOGS TO M.	TOTAL FEET
		12" to 16"	17" & Up	12" to 16"	17" & Up			
A	100	158	211			3½	10	369,000
B	57			148	521	3½	9	669,000
Total Feet								1,038,000

Growth Vigorous Quality Fair length, smooth and sound  
 Isolated or Grouped Scattered Injury None  
 Jeopardized by..... Preferred Method of Logging Tram and Carts

Method of Logging.....	HARDWOOD (M. FEET) SCRIBNER-DOYLE LOG SCALE—INSIDE BARK MEASUREMENT												TOTAL				
	AREA NO.	ACRES	TUPELO GUM	RED GUM		CYPRESS		WHITE OAK		RED OAK		HICK-ORY	ASH	BEECH	MAG-NOLIA	Feet	Ties
				Ties	Feet	Ties	Feet	Ties	Feet	Ties	Feet						
Nearest Stream.....	B	77		36	5			108	12	318	11					28,000	462
Reproduction <u>None</u>																	

Quality poor

Revised Courses and Distances

BEARING TREES

1. No bearing tree
2. 36" Pine E. 16V
3. No bearing tree
4. "

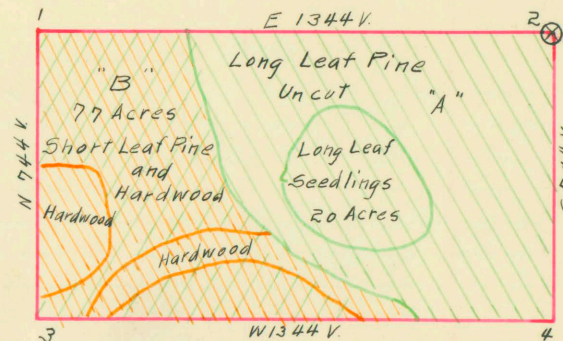



*In vault*

ABSTRACT NO. *261*

# RECORD OF TIMBER CUTTING

DATE	PINE						HARDWOOD												
	LONG LEAF		SHORT LEAF		TIES	PILING	TUPELO GUM	RED GUM		CYPRESS		WHITE OAK		RED OAK		HICKORY	ASH	BEECH	MAGNOLIA
	12" TO 16"	17" UP	12" TO 16"	17" UP				Ties	Feet	Ties	Feet	Ties	Feet	Ties	Feet				
<i>1911</i>																			
<i>June</i>	✓	<i>110 433</i>	<i>Camp 13</i>																
<i>July</i>	✓	<i>373 530</i>	✓	✓															
<i>August</i>	✓	<i>385 501</i>	✓	✓															
<i>Sept</i>	✓	<i>463 703</i>	✓	✓															
<i>October</i>	✓	<i>498 946</i>	✓	✓															
<i>November</i>	✓	<i>3 023</i>	✓	✓															
		<i>1834636</i>																	

*See W.O. Banks' form S.L-6 #159 dated 12/19/11 reporting this survey as denuded*

*Filed under heading camp 13.*