

H. O. CO. ACREAGE 636 SUB NO. Ausburn Harris SURVEY Hardin COUNTY, ABSTRACT NO. 268

Acreage found 636 Patentee _____ Estimated by Abe Magee Date November 10, 1910
 Timber Rights Expire _____ Mineral Rights Expire _____ H. O. Co. Represented by _____
 Encroachments, Conflict, Trespass, Houses, Fences, Fields None
 Has Land Been Cut Over? No When _____ By _____ Class of Timber Cut _____
 Topography Flat and brushy Soil Sandy Loam and Clay
 Adaptable for Agriculture Indications of _____

PINE REPRODUCTION				
Area No.	Acres			
	<u>636</u>			
L. L. Seedlings				
S. L. Seedlings				
L. L. 7"				
L. L. 8" to 11"				
S. L. 7"		<u>21M</u>		
S. L. 8" to 11"		<u>102M</u>		
Total Feet		<u>123M</u>		

MERCHANTABLE PINE (M. FEET) HERRING LOG SCALE—OUTSIDE BARK MEASUREMENT								
AREA NO.	ACRES	LONG LEAF		SHORT LEAF		LOGS TO TREE	LOGS TO M.	TOTAL FEET
		12" TO 16"	17" & UP	12" TO 16"	17" & UP			
	<u>636</u>			<u>489</u>	<u>2078</u>	<u>3½</u>	<u>9</u>	<u>2,567,000</u>
Total Feet								

Growth Vigorous Quality Fair, medium length and sound
 Isolated or Grouped Scattered Injury None
 Jeopardized by _____ Preferred Method of Logging Tram

Method of Logging	AREA NO.	ACRES	HARDWOOD (M. FEET) SCRIBNER-DOYLE LOG SCALE—INSIDE BARK MEASUREMENT										TOTAL				
			TUPELO GUM	RED GUM		CYPRESS		WHITE OAK		RED OAK		HICK-ORY	ASH	BEECH	MAG-NOLIA	Feet	Ties
				Ties	Feet	Ties	Feet	Ties	Feet	Ties	Feet						
Nearest Stream		<u>636</u>		<u>830</u>	<u>14</u>			<u>2018</u>	<u>58</u>	<u>1920</u>	<u>64</u>					<u>136,000</u>	<u>4,768</u>
Reproduction <u>None</u>																	

Quality coarse

Revised Courses and Distances

BEARING TREES

1. 12" Gum N. 45 E. 10V
2. No bearing tree marked 18" Pine
3. No bearing tree marked 18" Holly
4. No bearing tree marked 16" Pine
5. No bearing tree marked 30" Pine
6. 26" Pine N. 28 E. 5V

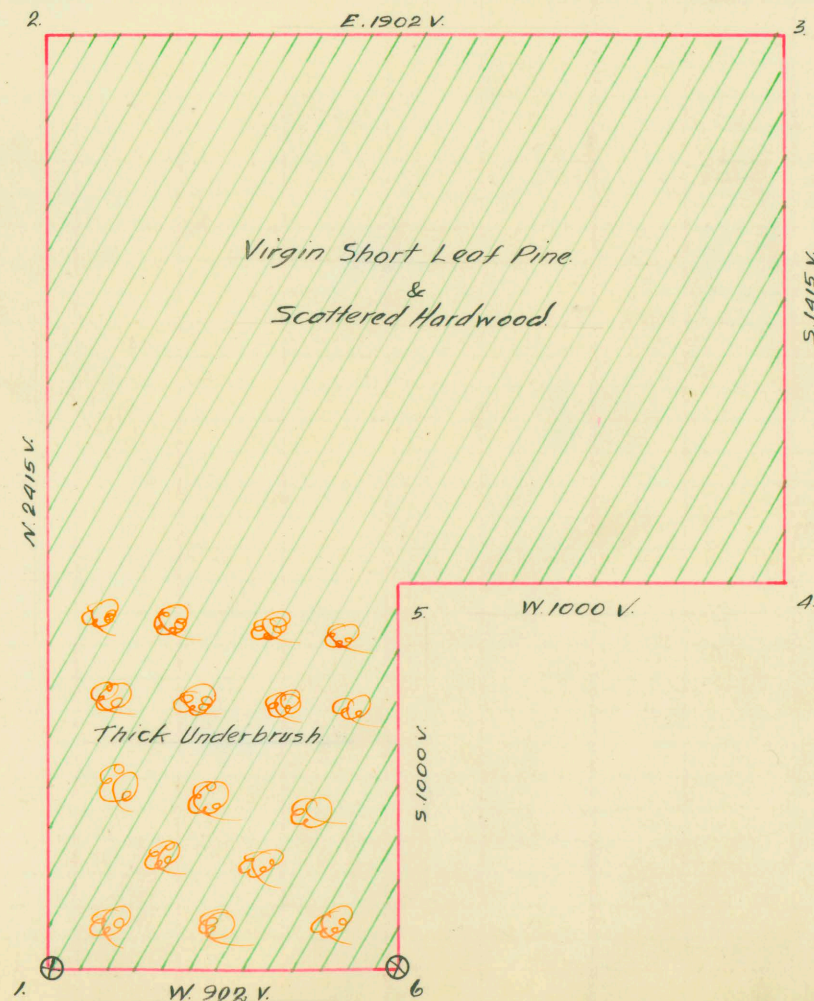

See
vaulet

ABSTRACT NO. 268

RECORD OF TIMBER CUTTING

DATE	PINE					HARDWOOD													
	LONG LEAF		SHORT LEAF		TIES	PILING	TUPELO GUM	RED GUM		CYPRESS		WHITE OAK		RED OAK		HICK- ORY	ASH	BEECH	MAG- NOLIA
	12" to 16"	17" UP	12" to 16"	17" UP				Ties	Feet	Ties	Feet	Ties	Feet	Ties	Feet				
1913 Dec	✓	684 899	Camp	13															
1914 Jan	✓	999 352		✓															
Feb.	✓	599 800		✓															
Mar.	✓	396 101		✓															
Apr	✓	23703		✓															
		<u>263335</u>																	

W. O. Banks' form L. S. 6 #323 Dated 1/15/15 reports this survey denuded of merchantable pine timber except about 62,000 feet

7000 under heading Camp 13