

H. O. CO. ACREAGE 320 SUB NO. H. & T.C. Sec. 180 SURVEY Hardin COUNTY, ABSTRACT NO. 576

Acreage found 320 Patentee _____ Estimated by H. H. Shaw Date November 7, 1910

Timber Rights Expire _____ Mineral Rights Expire _____ H. O. Co. Represented by _____

Encroachments, Conflict, Trespass, Houses, Fences, Fields Houses, Fields and Fences

Has Land Been Cut Over? Partly When 5-25 yrs. By _____ Class of Timber Cut Long Leaf Pine and Piling

Topography Rolling Soil Sandy

Adaptable for Forestry Indications of _____

PINE REPRODUCTION					MERCHANTABLE PINE (M. FEET) HERRING LOG SCALE—OUTSIDE BARK MEASUREMENT								
Area No.	A	B			AREA NO.	ACRES	LONG LEAF		SHORT LEAF		LOGS TO TREE	LOGS TO M.	TOTAL FEET
Acres	295	12					12" to 16"	17" & Up	12" to 16"	17" & Up			
L. L. Seedlings					A	295	540	2566			3½	5-7	3,106,000
S. L. Seedlings					B	12			23	83	3	4-8	106,000
L. L. 7"	10M												
L. L. 8" to 11"	68M												
S. L. 7"													
S. L. 8" to 11"		2M											
Total Feet	78M	2M			Total Feet								3,212,000

Growth Vigorous Quality Smooth

Isolated or Grouped Scattered Injury None

Jeopardized by _____ Preferred Method of Logging Tram

Method of Logging	AREA NO.	ACRES	TUPELO GUM	RED GUM		CYPRESS		WHITE OAK		RED OAK		HICK-ORY	ASH	BEECH	MAG-NOLIA	TOTAL		
				Ties	Feet	Ties	Feet	Ties	Feet	Ties	Feet					Feet	Ties	
Nearest Stream																		None
Reproduction																		

Revised Courses and Distances

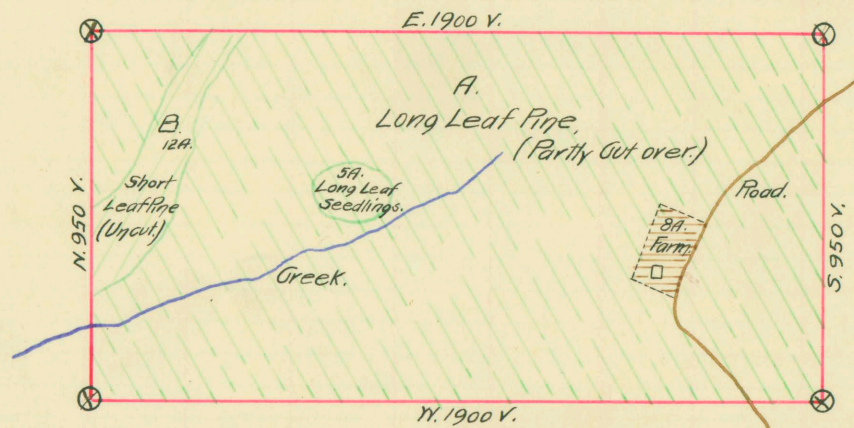

See
must

ABSTRACT NO. 516

RECORD OF TIMBER CUTTING

DATE	PINE					HARDWOOD														
	LONG LEAF		SHORT LEAF		TIES	PILING	TUPELO GUM	RED GUM		CYPRESS		WHITE OAK		RED OAK		HICKORY	ASH	BEECH	MAGNOLIA	
	12" to 16"	17" Up	12" to 16"	17" Up				Ties	Feet	Ties	Feet	Ties	Feet	Ties	Feet					
1912 Aug. ✓		233 564																		
Sept. ✓		612 274																		
Oct. ✓		1449 285																		
Nov. ✓		880 779																		
Dec. ✓		2290 322																		
1913 Jan. ✓		3404 934																		
		3654																		
		3406 588																		

W.O. Banks' form S.L. # 30 Dated 12/19/13 reports all merchantable Pine on this survey, including abstr. 568, except 455,000 feet, of which 400,000 ft is contained in defective trees.

Credit entered on this abstract to include all timber cut from abstr. 568 same survey.

Filed under heading camp 1.