

H. O. CO. ACREAGE 3454 SUB NO. 2 Sarah Gray SURVEY Jasper COUNTY, ABSTRACT NO. 152

Acreage found 3490 Patentee Estimated by H. H. Bilbo, W. S. Byrd Date December 1-2, 1910
 Timber Rights Expire Mineral Rights Expire H. O. Co. Represented by
 Encroachments, Conflict, Trespass, Houses, Fences, Fields Fence, Field, Houses
 Has Land Been Cut Over? Yes When 20 yrs. By Beaumont Lumber Co. Class of Timber Cut Long Leaf Pine
 Topography Flat and Marshy Soil Clay
 Adaptable for Grazing Indications of

PINE REPRODUCTION	
Area No.	Acres
4-A	640
5-B	120
L. L. Seedlings	
S. L. Seedlings	
L. L. 7"	13M
L. L. 8" to 11"	71M
S. L. 7"	42M
S. L. 8" to 11"	163M
Total Feet	84M 205M

MERCHANTABLE PINE (M. FEET) HERRING LOG SCALE—OUTSIDE BARK MEASUREMENT								
AREA NO.	ACRES	LONG LEAF		SHORT LEAF		LOGS TO TREE	LOGS TO M.	TOTAL FEET
		12" to 16"	17" & Up	12" to 16"	17" & Up			
4-A	640	600	1646			23	10	2,246,000
4-B				352	986	23	10	1,338,000
5-A	320	343	802			23	10	1,145,000
5-B	120			521	944	23	10	1,465,000
Total Feet		943	2448	873	1930			6,194,000

Growth Vigorous Quality Smooth, sound and short
 Isolated or Grouped Scattered Injury None
 Jeopardized by Preferred Method of Logging Tram

Method of Logging	AREA NO.	ACRES	HARDWOOD (M. FEET) SCRIBNER-DOYLE LOG SCALE—INSIDE BARK MEASUREMENT												TOTAL			
			TUPELO GUM	RED GUM		CYPRESS		WHITE OAK		RED OAK		HICKORY	ASH	BEECH	MAGNOLIA	Feet	Ties	
				Ties	Feet	Ties	Feet	Ties	Feet	Ties	Feet							
Nearest Stream	4-B			1400	30			410	14	1320	27						71,000	3,130
	5-BC	320	57	1000	20					1000	20						97,000	2,000
Reproduction	6	290		580	700	150	60	300	143	1000	175						1,078,000	2,030
																	1,246,000	7,160

Revised Courses and Distances South line is 1492 V longer than field notes call for on account of river changing its course.

H. O. Co. owns timber only.

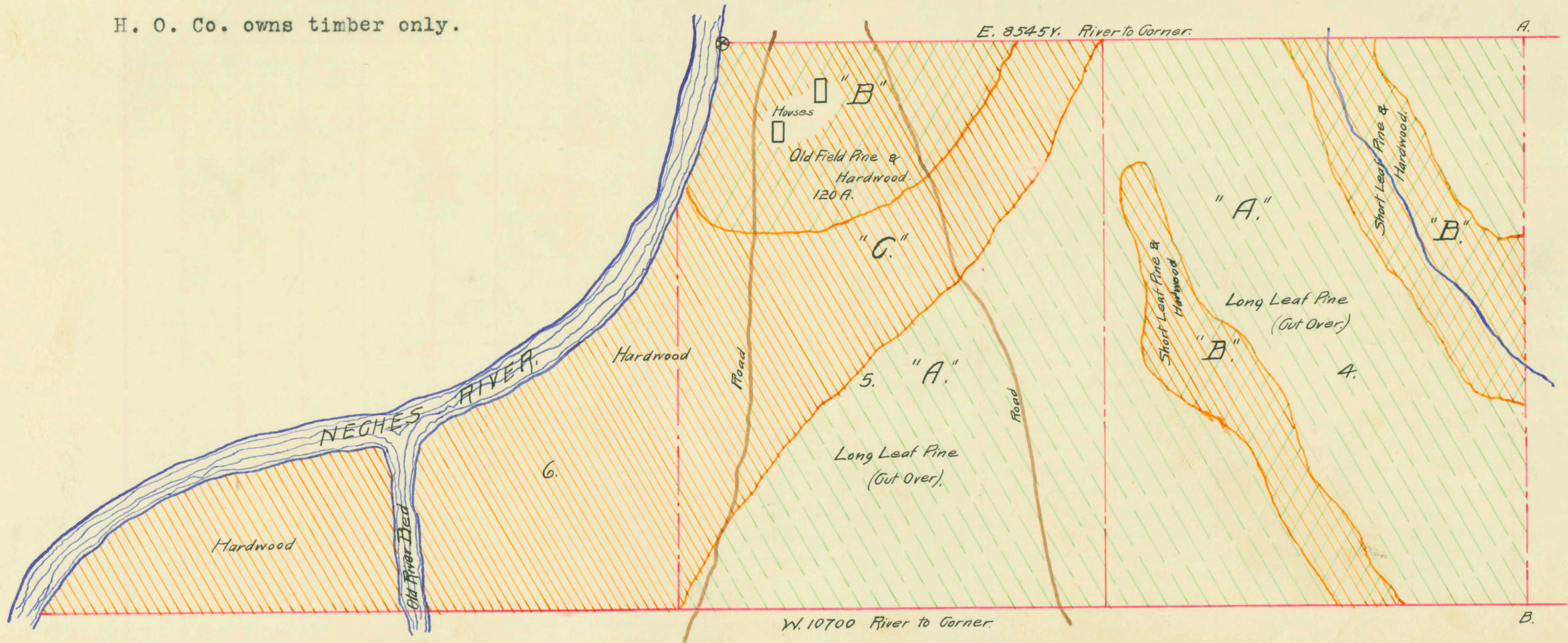

ABSTRACT NO. 152.

RECORD OF TIMBER CUTTING

DATE	PINE						HARDWOOD													
	LONG LEAF		SHORT LEAF		TIES	PILING	TUPELO GUM	RED GUM		CYPRESS		WHITE OAK		RED OAK		HICKORY	ASH	BEECH	MAGNOLIA	
	12" to 16"	17" UP	12" to 16"	17" UP				Ties	Feet	Ties	Feet	Ties	Feet	Ties	Feet					
1914 May	✓	233966	Camp 17	✓	W		N. L. Hawthorn's Form S. I. 6 # 398 Dated 4/6/16 reports													
June	✓	462381	✓	✓			this survey denuded of merchantable pine except													
July	✓	1991	✓	✓			approximately 100 acres on which stands 125,000													
Aug.	✓	Waste 2166	✓	✓			feet of mer. Pine +													
Dec.	✓	420593	✓	✓			feet of Hardwoods.													
		1120297	✓	✓																
1915 Feb.		5556490	✓	✓																
March.		5593405	✓	✓																
April.		3338039	✓	✓																
May.		11124679	✓	✓																
June.		91913772	✓	✓																
July.		151556844	✓	✓																
Aug.		7726885	✓	✓																
Sept.		131339855	✓	✓																
Oct.		141471843	✓	✓																
Nov.		Waste 1150405	✓	✓																
Dec.		22231779	✓	✓																
		10913693																		
1916 Jan.		Waste 218192	✓	✓																
Feb.		" 232	✓	✓																
		1113217																		
		11332117																		

This is what I obtain but figures are rather difficult to see.