

H. O. CO. ACREAGE 320 SUB NO. Lawrence & Creesy SURVEY Jasper COUNTY, ABSTRACT NO. 364

Acreage found 320 Patentee _____ Estimated by Earl Dionne Date August 13, 1910
 Timber Rights Expire _____ Mineral Rights Expire _____ H. O. Co. Represented by _____
 Encroachments, Conflict, Trespass, Houses, Fences, Fields Fence
 Has Land Been Cut Over? Yes When 20 yrs. By Beaumont Lumber Co. Class of Timber Cut Long Leaf Pine
 Topography Flat and Marshy Soil Sandy Loam
 Adaptable for Grazing Indications of _____

PINE REPRODUCTION	
Area No.	
Acres	<u>320</u>
L. L. Seedlings	
S. L. Seedlings	
L. L. 7"	<u>18M</u>
L. L. 8" to 11"	<u>110M</u>
S. L. 7"	
S. L. 8" to 11"	
Total Feet	<u>128M</u>

AREA NO.	ACRES	LONG LEAF		SHORT LEAF		LOGS TO TREE	LOGS TO M.	TOTAL FEET
		12" To 16"	17" & UP	12" To 16"	17" & UP			
	<u>320</u>	<u>1800</u>	<u>1756</u>					<u>3,556,000</u>
Total Feet								

Growth Vigorous Quality Sound but running into knots
 Isolated or Grouped Grouped Injury None
 Jeopardized by _____ Preferred Method of Logging Carts

Method of Logging	AREA NO.	ACRES	TUPELO GUM	RED GUM		CYPRESS		WHITE OAK		RED OAK		HICKORY	ASH	BEECH	MAGNOLIA	TOTAL		
				Ties	Feet	Ties	Feet	Ties	Feet	Ties	Feet					Feet	Ties	
Nearest Stream																		<u>None</u>
Reproduction																		

Revised Courses and Distances

H. O. Co. owns timber only.

BEARING TREES

1. Pine 18" N. 80° W. 12V
2. " 12" S. 50° W. 5V
3. " 22" E. 2V
4. " 11" S. 10° E.

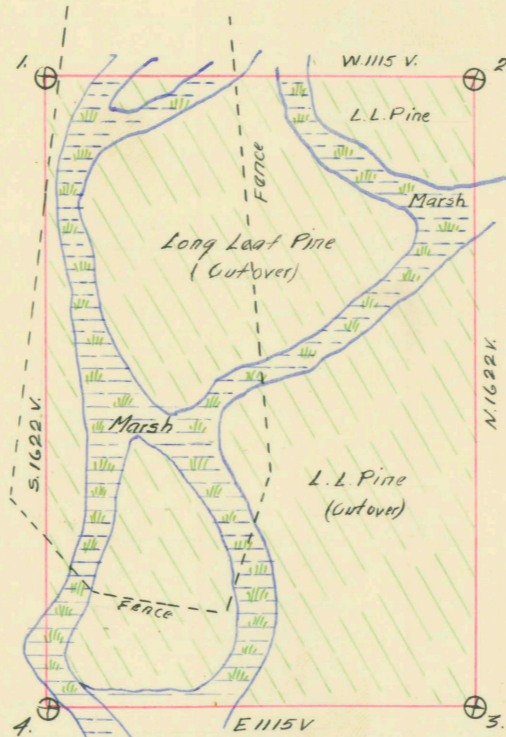

ABSTRACT NO. 364

RECORD OF TIMBER CUTTING

DATE	PINE						HARDWOOD													
	LONG LEAF		SHORT LEAF		TIES	PILING	TUPELO GUM	RED GUM		CYPRESS		WHITE OAK		RED OAK		HICKORY	ASH	BEECH	MAGNOLIA	
	12" to 16"	17" Up	12" to 16"	17" Up				Ties	Feet	Ties	Feet	Ties	Feet	Ties	Feet					
1914 Feb. ✓		1198977	camp 17																	
Mar. ✓		104309	" "																	
May ✓		5948	" "																	
July ✓		237703	" "																	
Aug. ✓		160738	" "																	
Sept. ✓		155857	" "																	
		<u>1863532</u>																		

W. L. Hawthorn's form S. I. - 6 - # 421 dated 11/28/14 reports this survey denuded of merchantable Pine.