

H. O. CO. ACREAGE 640 SUB NO. T.&N.O.R.R. Sec.48 SURVEY Jasper COUNTY, ABSTRACT NO. 904

Acreage found 640 Patentee Estimated by Abe Magee, Jr. Date August 24, 1910
 Timber Rights Expire Mineral Rights Expire H. O. Co. Represented by
 Encroachments, Conflict, Trespass, Houses, Fences, Fields None
 Has Land Been Cut Over? No When By Class of Timber Cut
 Topography Rolling Soil Sand
 Adaptable for Grazing and Agriculture Indications of

PINE REPRODUCTION	
Area No.	ACRES
A	360
B	280
L. L. Seedlings	
S. L. Seedlings	
L. L. 7"	17M
L. L. 8" to 11"	100M
S. L. 7"	2M
S. L. 8" to 11"	11M
Total Feet	117M 13M

MERCHANTABLE PINE (M. FEET) HERRING LOG SCALE—OUTSIDE BARK MEASUREMENT								
AREA NO.	ACRES	LONG LEAF		SHORT LEAF		LOGS TO TREE	LOGS TO M.	TOTAL FEET
		12" to 16"	17" & UP	12" to 16"	17" & UP			
A	360	1038	1935			4	12	2,973,000
B	280			114	219	3½	12	333,000
Total Feet								3,306,000

Growth Vigorous Quality Good
 Isolated or Grouped Scattered Injury None
 Jeopardized by Preferred Method of Logging Tram and Carts

HARDWOOD (M. FEET) SCRIBNER-DOYLE LOG SCALE—INSIDE BARK MEASUREMENT																	
Method of Logging	AREA NO.	ACRES	TUPELO GUM	RED GUM		CYPRESS		WHITE OAK		RED OAK		HICK-ORY	ASH	BEECH	MAG-NOLIA	TOTAL	
				Ties	Feet	Ties	Feet	Ties	Feet	Ties	Feet					Feet	Ties
Carts	B	280	111	2112	77		4	436	17	870	30		68			307,000	3,418
Reproduction	Small amount																

Fair quality, scattered

Revised Courses and Distances

BEARING TREES

- No corner
- 24" Magnolia S. 50° W. 5V
- 30" Pine S. 20° W. 2V
- 12" " E. 6V
- 8" Pin Oak S. 20° W. 2V
- No corner

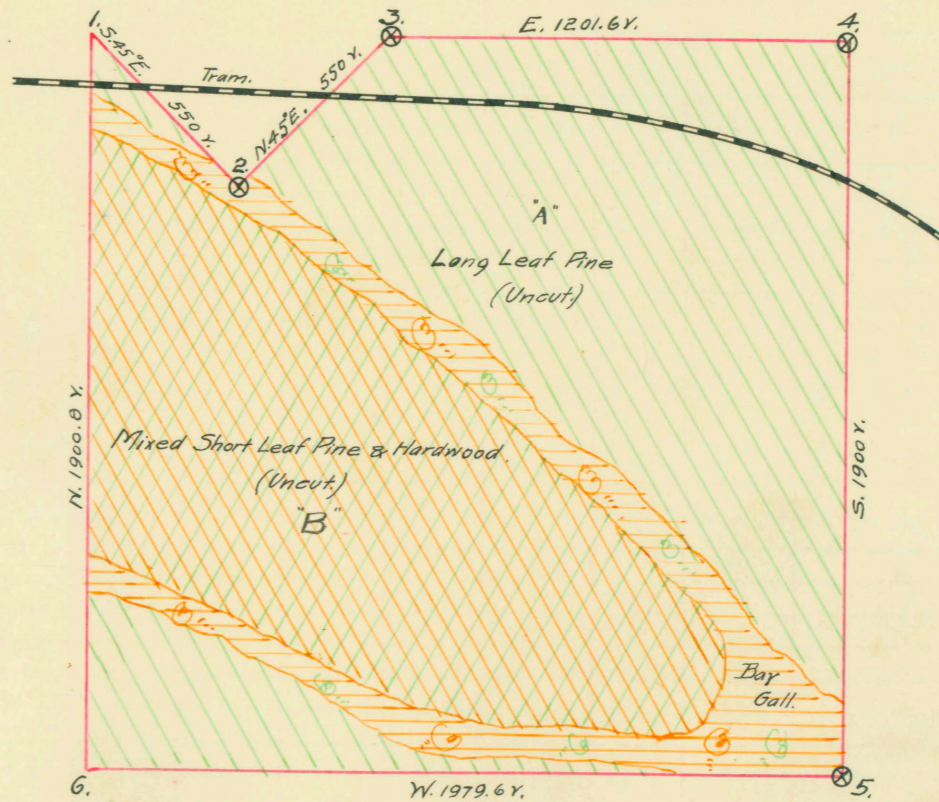

ABSTRACT NO. 904

RECORD OF TIMBER CUTTING

DATE	PINE						HARDWOOD												
	LONG LEAF		SHORT LEAF		TIES	PILING	TUPELO GUM	RED GUM		CYPRESS		WHITE OAK		RED OAK		HICKORY	ASH	BEECH	MAGNOLIA
	12" to 16"	17" Up	12" to 16"	17" Up				Ties	Feet	Ties	Feet	Ties	Feet	Ties	Feet				
1910 Dec		81820	Camp 3																
1911 Jan. ✓		161322	" "																
March. ✓		907897	" "																
April. ✓		1402017	" "																
May. ✓		182290	" "																
June. ✓		42666	" "																
July. ✓		4314	" "																
August. ✓		6039	" "																
Sept. ✓		4351	" "																
		<u>2792716</u>																	

Inspector W. C. Hu Bosis form S-I-6-#206
 Dated, 11/16/12, reports this survey denuded of
 Pine 12" and up except 15,000 feet.