

H. O. CO. ACREAGE 160 SUB NO. J. W. Beathard SURVEY Tyler COUNTY, ABSTRACT NO. 166

Acreage found 160 Patentee Estimated by A. L. McDonald Date October 31, 1910

Timber Rights Expire Mineral Rights Expire H. O. Co. Represented by

Encroachments, Conflict, Trespass, Houses, Fences, Fields None

Has Land Been Cut Over? Yes When 2 yrs. By Kirby Lumber Co. Class of Timber Cut Long and Short Leaf Pine

Topography Flat Soil Sand

Adaptable for Grazing Indications of

PINE REPRODUCTION

Area No.	B			
Acres	105			
L. L. Seedlings				
S. L. Seedlings				
L. L. 7"				
L. L. 8" to 11"				
S. L. 7"	3M			
S. L. 8" to 11"	19M			
Total Feet	22M			

MERCHANTABLE PINE (M. FEET) HERRING LOG SCALE—OUTSIDE BARK MEASUREMENT

AREA NO.	ACRES	LONG LEAF		SHORT LEAF		LOGS TO TREE	LOGS TO M.	TOTAL FEET
		12" TO 16"	17" & UP	12" TO 16"	17" & UP			
A	35	14	26					40,000
B	105			44	99			143,000
Total Feet								183,000

Growth Quality Good

Isolated or Grouped Injury None

Jeopardized by Preferred Method of Logging Tram

HARDWOOD (M. FEET) SCRIBNER-DOYLE LOG SCALE—INSIDE BARK MEASUREMENT

Method of Logging	AREA NO.	ACRES	TUPELO GUM	RED GUM		CYPRESS		WHITE OAK		RED OAK		HICK-ORY	ASH	BEECH	MAG-NOLIA	TOTAL	
				Ties	Feet	Ties	Feet	Ties	Feet	Ties	Feet					Feet	Ties
Nearest Stream	B	125		200	125		20		30	300	50			35	15	275,000	500
Reproduction	None																

Quality good

Revised Courses and Distances

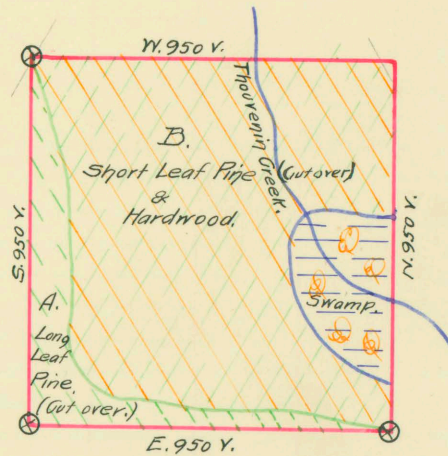

*See
sheet*

ABSTRACT NO. 1166

RECORD OF TIMBER CUTTING

DATE	PINE						HARDWOOD																																																																																																																						
	LONG LEAF		SHORT LEAF		TIES	PILING	TUPELO GUM	RED GUM		CYPRESS		WHITE OAK		RED OAK		HICKORY	ASH	BEECH	MAGNOLIA																																																																																																										
	12" to 16"	17" Up	12" to 16"	17" Up				Ties	Feet	Ties	Feet	Ties	Feet	Ties	Feet																																																																																																														
1911	March	✓	127 #80	✓																																																																																																																									
	April	✓	255 #31	✓																																																																																																																									
	May	✓	176 #01	✓																																																																																																																									
	June	✓	1003	✓																																																																																																																									
	July	✓	314	✓																																																																																																																									
			560 #24																																																																																																																										
1910	July																																																																																																																												
	Aug.																																																																																																																												
				<p><i>Camp 1 (Village, Niles)</i></p> <p><i>Inspector W. O. Banks found S. L. #174 12/19/12 reports this survey demanded of merchantable Pine except 5,000 feet in defective trees</i></p>																																																																																																																									
				<p><i>Hardwood Timber Character & Classification of cutting 1912.</i></p> <table border="1"> <tr> <td>Jan.</td> <td>Pole Ties</td> <td></td> <td></td> <td></td> <td></td> <td></td> <td></td> <td></td> <td></td> <td></td> <td></td> <td></td> <td></td> <td></td> <td></td> <td></td> <td></td> <td></td> <td></td> <td></td> </tr> <tr> <td>Mar.</td> <td>" "</td> <td></td> <td></td> <td></td> <td></td> <td>21</td> <td></td> <td></td> <td></td> <td></td> <td></td> <td>107</td> <td></td> <td></td> <td>147</td> <td></td> <td></td> <td></td> <td></td> <td></td> </tr> <tr> <td>Aug.</td> <td>" "</td> <td></td> <td></td> <td></td> <td></td> <td></td> <td></td> <td></td> <td></td> <td></td> <td></td> <td>343</td> <td></td> <td></td> <td>192</td> <td></td> <td></td> <td></td> <td></td> <td>35</td> </tr> <tr> <td>Oct.</td> <td>" "</td> <td></td> <td></td> <td></td> <td></td> <td></td> <td></td> <td></td> <td></td> <td></td> <td></td> <td>70</td> <td></td> <td></td> <td>33</td> <td></td> <td></td> <td></td> <td></td> <td></td> </tr> <tr> <td></td> <td></td> <td></td> <td></td> <td></td> <td></td> <td></td> <td></td> <td></td> <td></td> <td></td> <td></td> <td></td> <td></td> <td></td> <td>19</td> <td></td> <td></td> <td></td> <td></td> <td>11</td> </tr> </table>																	Jan.	Pole Ties																				Mar.	" "					21						107			147						Aug.	" "											343			192					35	Oct.	" "											70			33																					19					11
Jan.	Pole Ties																																																																																																																												
Mar.	" "					21						107			147																																																																																																														
Aug.	" "											343			192					35																																																																																																									
Oct.	" "											70			33																																																																																																														
															19					11																																																																																																									

7 days in the feeding camp 1