

H. O. CO. ACREAGE 640 SUB NO. E. T. R. R. Co. Sec. 17 SURVEY Tyler COUNTY, ABSTRACT NO. 237

Acres found 640 Patentee \_\_\_\_\_ Estimated by H. H. Bilbo Date November 3, 1910  
 Timber Rights Expire \_\_\_\_\_ Mineral Rights Expire \_\_\_\_\_ H. O. Co. Represented by \_\_\_\_\_  
 Encroachments, Conflict, Trespass, Houses, Fences, Fields None  
 Has Land Been Cut Over? Partly When \_\_\_\_\_ By \_\_\_\_\_ Class of Timber Cut Long Leaf Pine  
 Topography Flat and Swampy Soil Alluvial and Sandy  
 Adaptable for Agriculture and Forestry Indications of \_\_\_\_\_

**PINE REPRODUCTION**

Area No.	A	B			
Acres	130	510			
L. L. Seedlings					
S. L. Seedlings					
L. L. 7"	13M				
L. L. 8" to 11"	49M				
S. L. 7"		7M			
S. L. 8" to 11"		30M			
Total Feet	62M	37M			

**MERCHANTABLE PINE (M. FEET) HERRING LOG SCALE—OUTSIDE BARK MEASUREMENT**

AREA NO.	ACRES	LONG LEAF		SHORT LEAF		LOGS TO TREE	LOGS TO M.	TOTAL FEET
		12" to 16"	17" & Up	12" to 16"	17" & Up			
A	130	259	1734			4	11	1,993,000
B	510			892	2410	4-5	14	3,302,000
Total Feet								5,295,000

Growth Vigorous Quality Good  
 Isolated or Grouped Scattered Injury None  
 Jeopardized by \_\_\_\_\_ Preferred Method of Logging Tram

**HARDWOOD (M. FEET) SCRIBNER-DOYLE LOG SCALE—INSIDE BARK MEASUREMENT**

Method of Logging	AREA NO.	ACRES	TUPELO GUM	RED GUM		CYPRESS		WHITE OAK		RED OAK		HICK-ORY	ASH	BEECH	MAG-NOLIA	TOTAL	
				Ties	Feet	Ties	Feet	Ties	Feet	Ties	Feet					Feet	Ties
Nearest Stream	B	510		2430	128			2700	274	2850	146	20	22		94	684,000	7,980
Reproduction																	

Quality good

Revised Courses and Distances

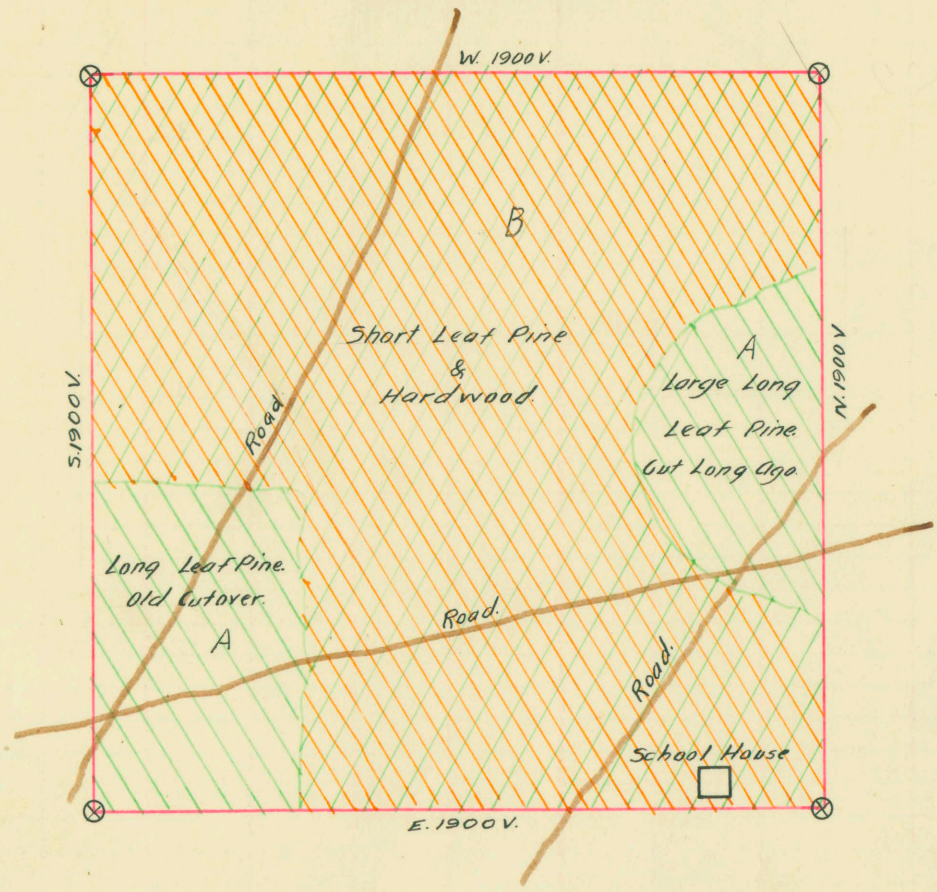

See vault ✓

ABSTRACT NO. 237

# RECORD OF TIMBER CUTTING

DATE	PINE				TIES	PILING	TUPELO GUM	HARDWOOD											
	LONG LEAF		SHORT LEAF					RED GUM		CYPRESS		WHITE OAK		RED OAK		HICKORY	ASH	BEECH	MAGNOLIA
	12" TO 16"	17" UP	12" TO 16"	17" UP				Ties	Feet	Ties	Feet	Ties	Feet	Ties	Feet				
1920 April		30553	Complete																
1921 Jan.		627395																	
Feb.		784569																	
March		247988																	
April		76522																	
May		524																	

These numbers are loadings of Camp 6.