

H. O. CO. ACREAGE 320 SUB NO. Thomas Keitch SURVEY Tyler COUNTY, ABSTRACT NO. 425

Acreage found 320 Patentee _____ Estimated by C. N. Otey, Jr. Date November 1, 1910
 Timber Rights Expire _____ Mineral Rights Expire _____ H. O. Co. Represented by _____
 Encroachments, Conflict, Trespass, Houses, Fences, Fields House
 Has Land Been Cut Over? Yes When _____ By Kirby Lumber Co. Class of Timber Cut Long Leaf Pine
 Topography Rolling Soil Sand and Clay
 Adaptable for Grazing and Agriculture Indications of _____

PINE REPRODUCTION

| Area No. | A | B | | |
|-----------------|-----|-----|--|--|
| Acres | 220 | 100 | | |
| L. L. Seedlings | | | | |
| S. L. Seedlings | | | | |
| L. L. 7" | 5M | | | |
| L. L. 8" to 11" | 40M | | | |
| S. L. 7" | | 1M | | |
| S. L. 8" to 11" | | 9M | | |
| Total Feet | 45M | 10M | | |

MERCHANTABLE PINE (M. FEET) HERRING LOG SCALE—OUTSIDE BARK MEASUREMENT

| AREA NO. | ACRES | LONG LEAF | | SHORT LEAF | | LOGS TO TREE | LOGS TO M. | TOTAL FEET |
|------------|-------|------------|----------|------------|----------|--------------|------------|------------|
| | | 12" TO 16" | 17" & UP | 12" TO 16" | 17" & UP | | | |
| A | 220 | 178 | 143 | | | | | 321,000 |
| B | 100 | | | 39 | 178 | | | 217,000 |
| Total Feet | | | | | | | | 538,000 |

Growth Fair Quality Medium
 Isolated or Grouped Scattered Injury _____
 Jeopardized by _____ Preferred Method of Logging Tram

HARDWOOD (M. FEET) SCRIBNER-DOYLE LOG SCALE—INSIDE BARK MEASUREMENT

| Method of Logging | AREA NO. | ACRES | TUPELO GUM | RED GUM | | CYPRESS | | WHITE OAK | | RED OAK | | HICK-ORY | ASH | BEECH | MAG-NOLIA | TOTAL | |
|-------------------|-------------|-------|------------|---------|------|---------|------|-----------|------|---------|------|----------|-----|-------|-----------|---------|------|
| | | | | Ties | Feet | Ties | Feet | Ties | Feet | Ties | Feet | | | | | Feet | Ties |
| Nearest Stream | B | 100 | | 186 | 163 | 75 | 80 | 120 | 199 | 324 | 160 | 4 | | 23 | 14 | 643,000 | 705 |
| Reproduction | <u>None</u> | | | | | | | | | | | | | | | | |

Quality fair

Revised Courses and Distances

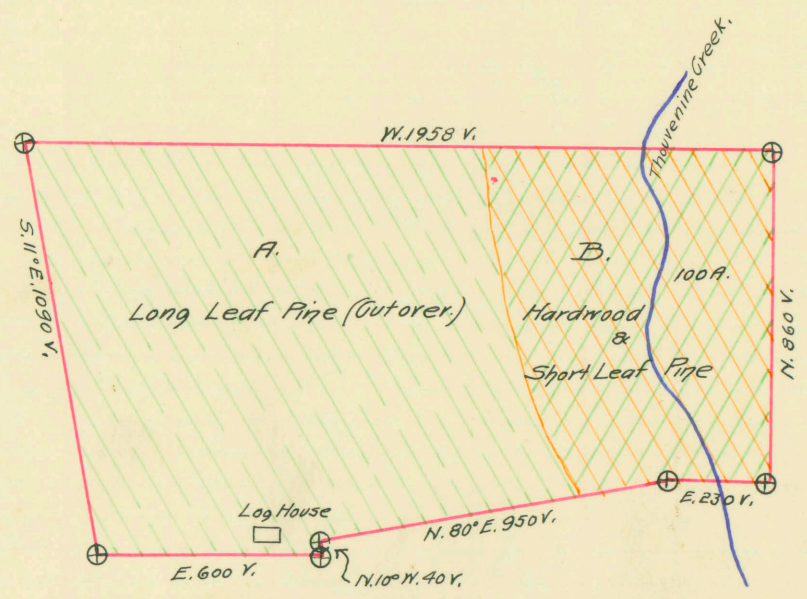

In vault

ABSTRACT NO. *425*

RECORD OF TIMBER CUTTING

| DATE | PINE | | | | | | HARDWOOD | | | | | | | | | | | | |
|---|------------|------------------------------------|------------------------|--------|------|--------|------------|---------|------|---------|------|-----------|------|---------|------|---------|-----|-------|----------|
| | LONG LEAF | | SHORT LEAF | | TIES | PILING | TUPELO GUM | RED GUM | | CYPRESS | | WHITE OAK | | RED OAK | | HICKORY | ASH | BEECH | MAGNOLIA |
| | 12" to 16" | 17" Up | 12" to 16" | 17" Up | | | | Ties | Feet | Ties | Feet | Ties | Feet | Ties | Feet | | | | |
| <i>Febry March</i> | | <i>37 213 38 096 15369</i> | <i>Clump (Village)</i> | | | | | | | | | | | | | | | | |
| <p><i>Inspector W.O. Banks form S.L. 6 #17 12/20/12 reports 300,000 feet Merchantable Pine uncut on west side Shaverpin Creek</i></p> | | | | | | | | | | | | | | | | | | | |

Filed under heading camp 1.